

Valves

Slice Valves

CMP now offers a complete line of Slice Valves in a variety of configurations used in Pool and Spa applications. These are assembled as one complete unit with 100% shut off capabilities. For an open position the tee handle and stem pulls up and slides into a locking position. A press fit Slice Valve Lock is attached and included with each valve which snaps onto the stem and assures maintaining a full flow open position.

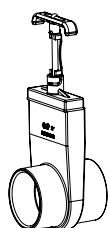

Socket x Socket

25850-150 1.5"
25850-200 2"

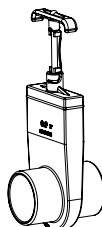

Spigot x Spigot

25851-150 1.5"
25851-200 2"



Spigot x Socket

25852-150 1.5"
25852-200 2"



Spigot x Male Union

25853-150 1.5"
25853-200 2"

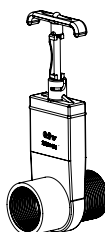

MIP x FIP

25854-150 1.5"



FIP x Split Nut

25855-150 1.5"

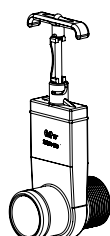

MIP x Hose Adapter

25856-150 1.5"

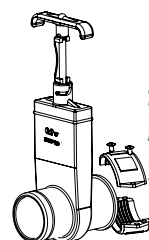

Split Nut x Hose Adapter

25857-150 1.5"

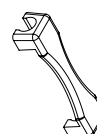

Slice Valve Lock

Included with each valve
25850-000-100



Multiport Valve

1.5" 6-Way Multiport Valve

27200-000

- Compare to a PRA T-12 Valve

Replacement Parts on Page A71