

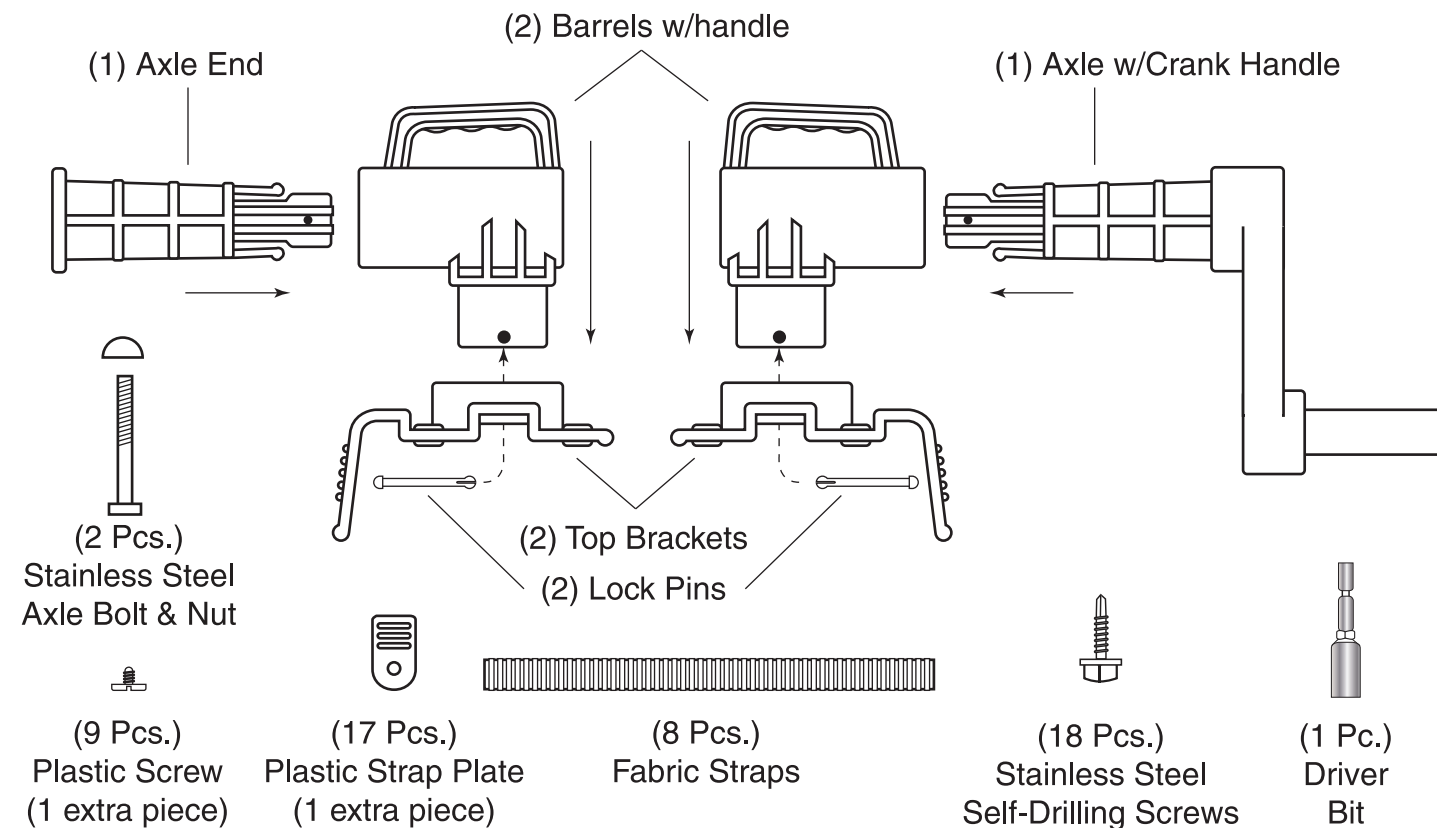

Item # 5000

Advanced Reel System For Above Ground Solar Pool Covers

1. Congratulation on your purchase of our Swimline Hydrottools Solar Reel™ for Above Ground Pools. Please follow the instructions carefully so as to not void our warranty.
2. Please use your solar blanket and reel assembly in the manner it was intended for:
 - a. Your solar blanket is not a safety cover
 - b. Remove the solar blanket and Solar Reel™ assembly from the pool completely before swimming use.
 - c. Do not store the solar blanket on the ground in direct sunlight, as it will burn the lawn
3. **Preparation & Assembly:** Check inventory of all items and assemble as illustrated below:



4. Depending upon the size of your pool you will also require one of the following pole sets:

Item #5018 Pole Set

(fits up to 18' width pool)
Contains:
(3) 57" x1-1/2" Diameter extruded aluminum shaft
(2) 57" x1-5/8" Diameter extruded aluminum shaft
(25) SS Screws (1 extra)

Item #5024 Pole Set

(fits up to 24' width pool)
Contains:
(3) 66" x1-1/2" Diameter extruded aluminum shaft
(2) 66" x1-5/8" Diameter extruded aluminum shaft
(25) SS Screws (1 extra)

Item #5030 Pole Set

(fits up to 30' width pool)
Contains:
(4) 59" x1-1/2" Diameter extruded aluminum shaft
(3) 59" x1-5/8" Diameter extruded aluminum shaft
(37) SS Screws (1 extra)

5. Positioning Your Solar Reel:

For Rectangular pools, place top-rail brackets at either end of pool.

For Oval pools, place top-rail brackets at either end of pool where radius begins.

For Round pools, place top-rail brackets at center of pool. (See Illustrations below)

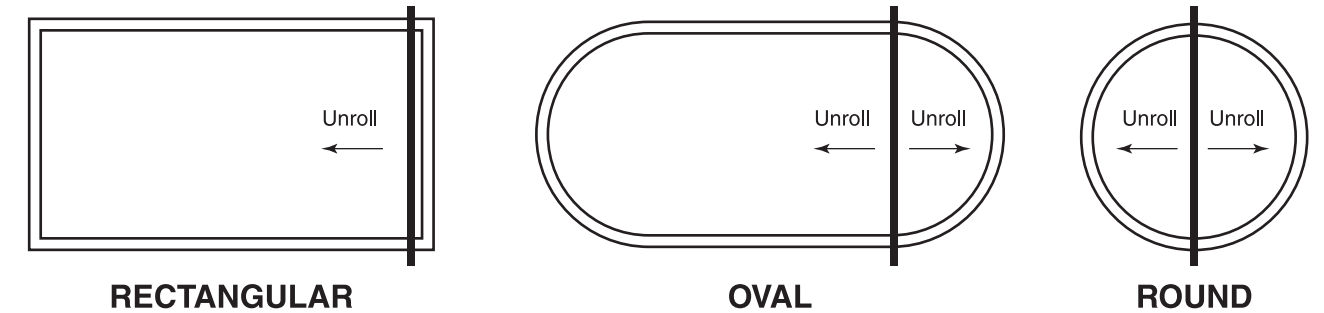

6. Trimming Your Solar Blanket:

- Lay your Solar Blanket (not provided) on top of water.

IMPORTANT! Oval & Round Pool owners will need to fold their solar covers at point of placement of brackets! The cover will unroll left and right of brackets & cross pole. Please allow 6 inches more material on length to allow for a fold where straps will be attached for wind onto reel system. (See Illustrations above)

- With scissors trim blanket to fit shape of pool. Be sure to clear the inside top rail of pool.

7. Permanently Mounting Your Solar Reel Brackets

At some point, you may decide to permanently mount top rail brackets to the top rail of the pool. This creates a handy "Socket" to accept your Solar Reel Crank & Barrel. You can permanently mount brackets at any time once you have developed a confidence level in the correct positioning and assembly of all parts. If mounted to top rail, you do not need the lock pin that holds barrel to top plate. Brackets are attached to top rail through the four countersunk holes in the rail brackets. Exercise caution before drilling any holes in your pool top rail to avoid damaging wall or liner. Lock Pins can be installed or removed by tapping in or out with a punch and hammer. (See Illustrations)

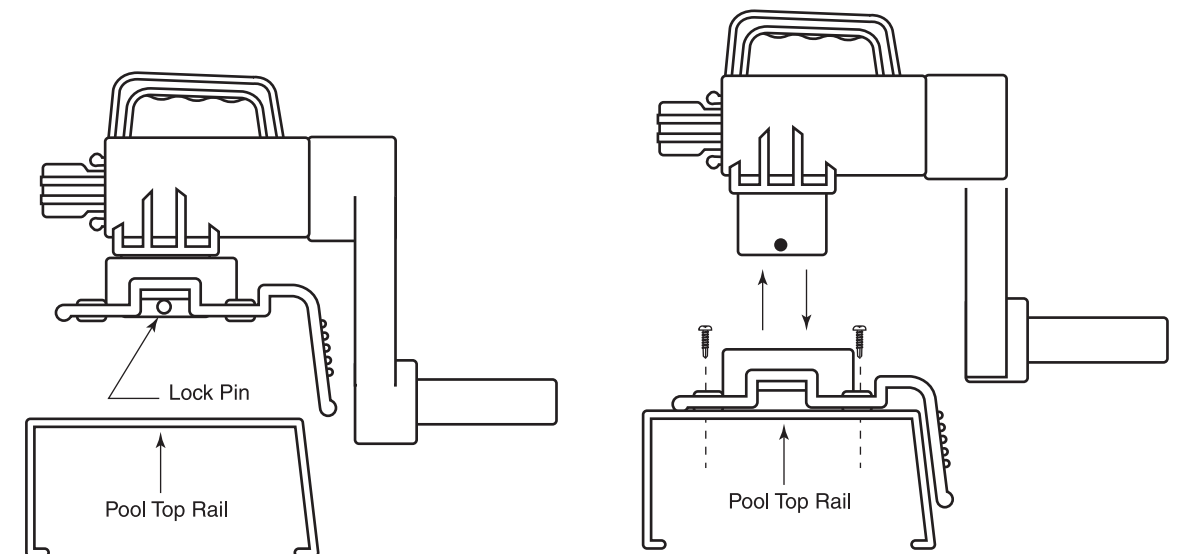

NON-PERMANENT ASSEMBLY

SOCKET STYLE ASSEMBLY