

Jet Cleaner

Operating Instructions



ENGLISH

Dear Customer,

Thank you for choosing our Jet Unit to clean your pool. We hope that you will enjoy using your new Jet Unit to maintain your swimming pool for years to come.

The Jet Unit is the only fully automatic robotic pool cleaner with a powerful jet drive propulsion system. Before you begin to use the cleaner, please take a few minutes to carefully read the Operator Instructions.

Again, thank you for choosing our Jet Unit.

DO NOT SWIM WHILE CLEANER IS IN USE

- | | |
|-----------------------------|-----------------------|
| 1. fuse | 9. body |
| 2. transformer cable plug | 10. wheel |
| 3. transformer 115 V ~ 60Hz | 11. handle |
| 4. power switch ON/OFF | 12. bottom housing |
| 5. socket | 13. jet valve housing |
| 6. Built-in timer | 14. jet outlet |
| 7. floating cable plug | 15. lock pin |
| 8. floating cable | |



WARNING

Read all safety instructions carefully and keep for later reference.
Observe all warnings and instructions marked on power supply and cleaner.

Keep power supply away from heavy rain or placed in puddles of water!

Use only the power supply that was supplied with your cleaner.
If there is a question, consult your local dealer or service center.

Do not use your power supply if:

- (1) Power cord is damaged or frayed.
- (2) The power supply had been dropped in the pool or exposed to heavy rain.
- (3) If the power supply has a broken socket.

Please consult your dealer or qualified service center for help.
Do not attempt to repair broken power cord or power supply.
Contact your dealer or service center.
Mishandling of the unit can result in leakage of lubricants.

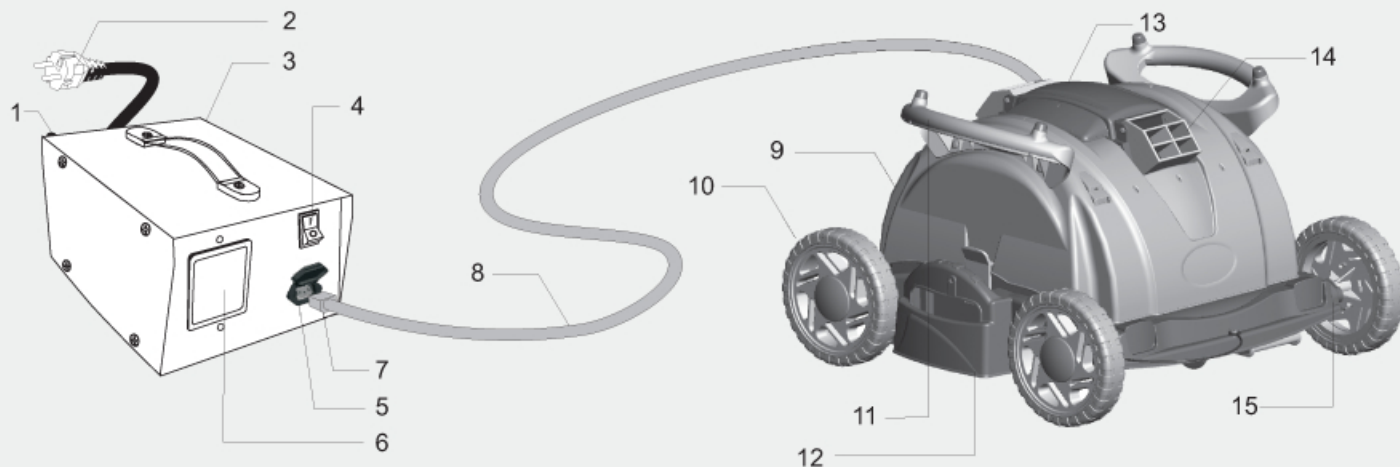

Operating Instructions

Your new automatic pool cleaner contains:

- A. Robotic Pool Cleaner and floating cable.
- B. Power Supply (transformer)

Please read this Manual completely before operating your Pool Cleaner.

1. Place the power supply (transformer) at least 3.5 meters (12 feet) from the pool. (See figure 2).
2. Uncoil the cable (See figure 3).
3. Make sure that the power supply switch is in the "OFF" position (See figure 4).
4. Plug the cable into the socket on the power supply (See figure 5):
5. Place the unit in the water. Turn the unit side to side in the water to allow air to escape from the body and then let the cleaner sink to the bottom of the pool (See figure 6). Then spread the floating cable over the surface of the pool as evenly as possible making sure it is not tangled or kinked.
6. Plug the transformer cord into a 115V~ three grounded outlet (See figure 8).
7. Turn the transformer ON.

IMPORTANT: Please be sure to always keep the cleaner properly stored anywhere between 10 to 40 degrees Celsius (50 to 104 degrees Fahrenheit). This will keep the motor, plastics and seals protected. Failure to comply, will result in loss of warranty.

CAUTION: Do not switch the pool cleaner "ON" if it is not fully immersed in water. Operating the cleaner out of water will cause severe damage immediately and will result in loss of warranty. Allow the cleaner to remain in the pool for 15 to 20 minutes following the end of its cleaning cycle. This will allow the motors to cool adequately. Do not leave the cleaner in the pool all the time. Always remember to turn the power supply "OFF" and unplug it from the power outlet before removing the cleaner from the pool.

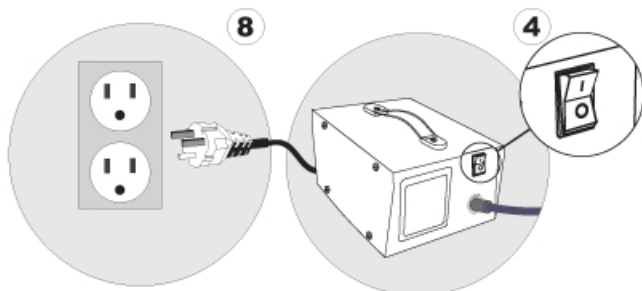
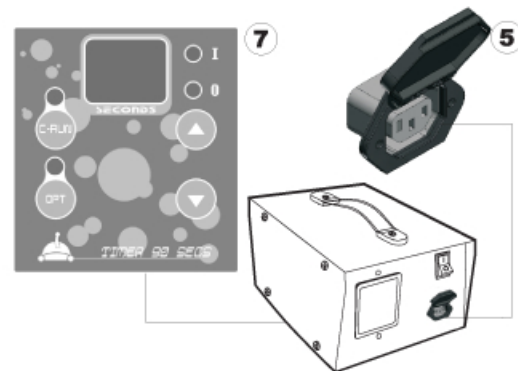
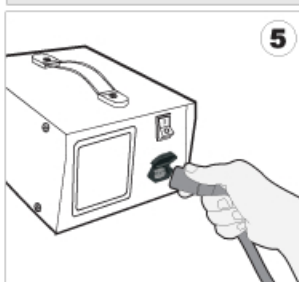
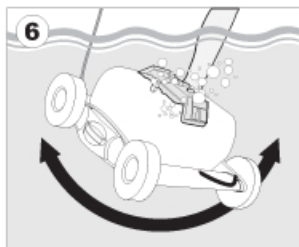
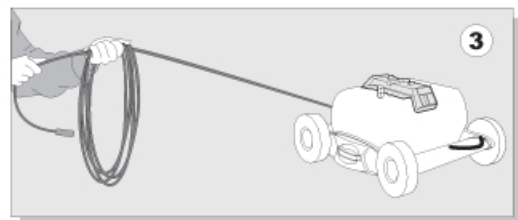
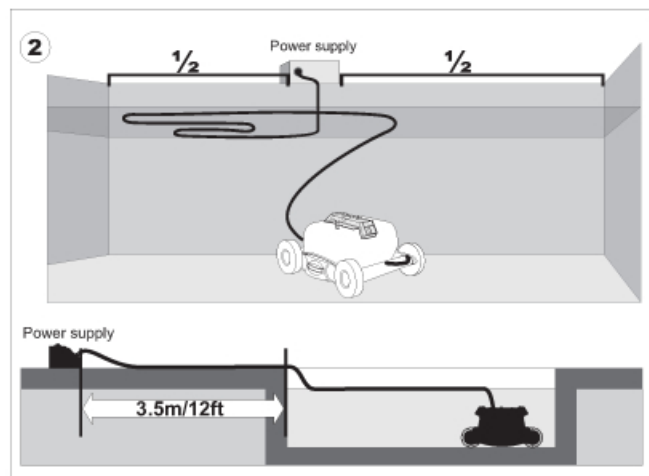

Operating Instructions

7 Hour Timer Operating Instructions

Your Cleaner is equipped with a 7 HOUR DIGITAL TIMER located on the power supply. This timer is simple to operate and offers two cleaning modes - Timed and Continuous cleaning.

To operate it please do the following:

Switch the power supply ON pressing the main switch. The display will flash two horizontal bars until you select either CONTINUOUS or TIMED operation.

Continuous Operation: Press the C-RUN button. Both the Green LED above the button and the Red "ON" LED will illuminate. The cleaner will now clean your pool until you stop it by switching the Power Switch to the "OFF" position.

Timed Operation: STEP1: Press the "UP" arrow button once for each hour of operation you desire up to 7 hours).
STEP2: When you have selected the proper number of hours, press the RESET button to set the timer

Changing Time Setting: After you have set the cleaning time you may add or subtract hours by simply pressing the "UP" or "DOWN" arrow buttons. This may be done WHILE THE CLEANER IS OPERATING IN THE POOL.

IMPORTANT: If you shut off the Power Supply this action will cancel the programming you have entered. To resume cleaning you must repeat the procedures listed above.



1. LED display
2. Continuous Operation Mode LED
3. C-RUN Continuous Operation Mode button
4. Timer Operation Mode LED
5. OPT Timer Operation Mode button
6. Timer is in operation LED
7. Timer is turned off LED
8. Time selector button increase value
9. Time selector button decrease value



CAUTION: TO REDUCE THE RISK OF ELECTRICAL SHOCK, DO NOT REMOVE SCREWS. NO USER SERVICEABLE PARTS INSIDE. REFER SERVICING TO QUALIFIED SERVICE PERSONAL.

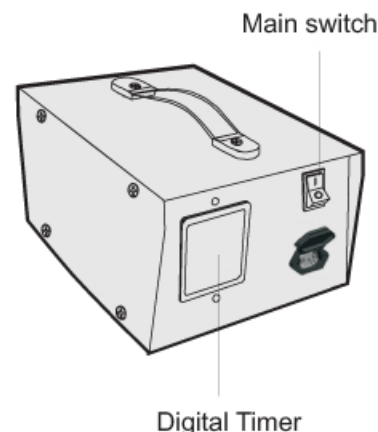

SETTING THE CLEANING PATTERN

Your Jet cleaner is packed with the wheel locked behind the Lock-Pin. To set the cleaning pattern, please lock the wheel in front of the Lock-Pin as in Fig. 16 or Fig. 18.

After your Jet cleaner completes its cleaning cycle, remove the cleaner from the pool and transfer the lock-pin from the right side of the unit to the left side (vice-versa).

Next time you use your Jet cleaner the cleaning unit will clean the pool in the opposite pattern. This will ensure that your cleaner completely cleans your pool.

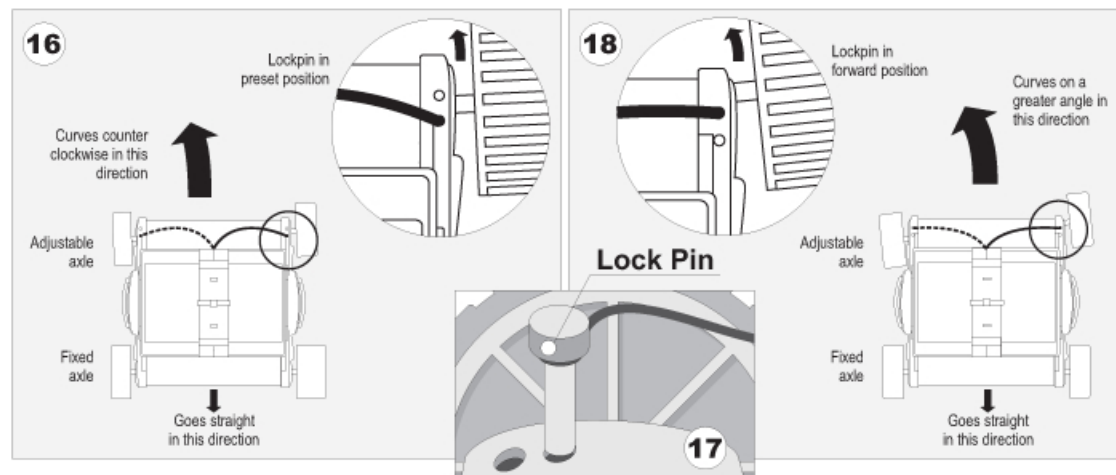

ADJUSTING THE CLEANER FOR YOUR POOL

The cleaner uses a systematic cleaning pattern that allows the cleaner to go back and fourth in overlapping patterns. The cleaner may be used to clean a variety of different size pools, up to 40'. Before its first use, you must set up the cleaner for your pool. To adjust the cleaner you will use the **axle locking pin**. (Fig. 17). There is one locking pin permanently attached to the unit with a lanyard.

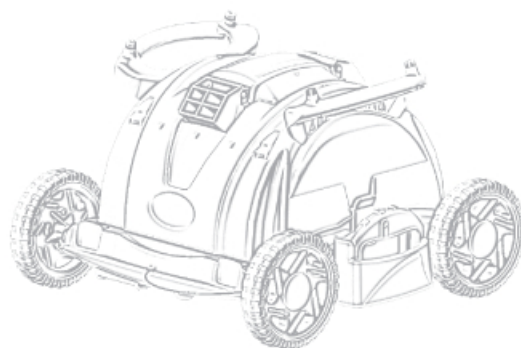
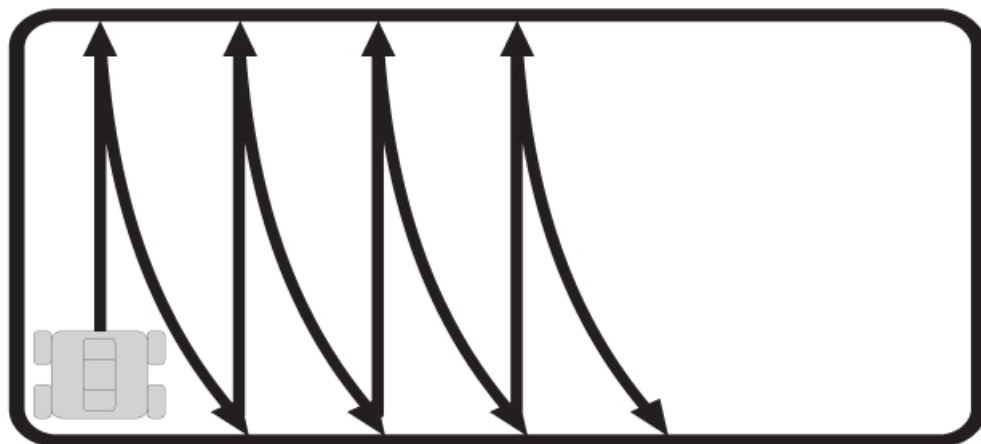

Adjusting the Suction Inlets

These cleaners have specially designed Bottom Lids with Adjustable Suction Inlets to customize and maximize the cleaner's effectiveness for varying applications. For best Results, position the Suction Inlets as low as possible without them coming in contact with any obstacles on the pool floor. If adjusting the Suction Inlets make sure they do not make contact with any part of the floor as the cleaner climbs slopes and over transitions.

To adjust the Suction Inlets first turn the cleaner upside down and locate the philips-head screws on the side of each Suction Inlet. Loosen the philips-head screws and the Suction Inlet will freely slide up and down inside the base of the cleaner. Hold the Suction Inlet at the desired position and tighten the philips-head screws until the Suction Inlet stays in position.

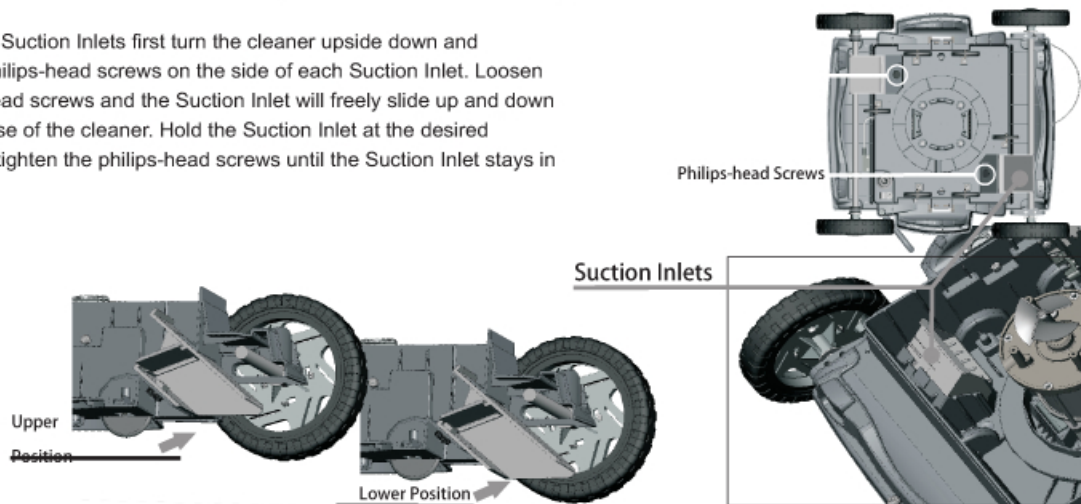

Filter Cartridge Removal and Cleaning:

This cleaner uses a large round Filter Cartridge for its internal filter apparatus. This reusable cartridge provides greater surface area with which to trap dirt and other debris. All debris pulled into the bottom of the Cleaner is stopped by the pleated Filter, and clean water exits the top of the cleaner. After every use, wash the dirt and debris from inside the Body and off the Cartridge.

Before removing the upper body to clean the Filter Cartridge, make sure the Cleaner is turned OFF and it is unplugged from the Power Supply. As a safety feature, the **Safety Switch Lockout** will automatically turn off the Motor if the upper body is removed. This is to protect hands and clothing from the exposed propeller of the Pump Motor sitting on the lower body. Never bypass the Safety Switch Lockout. Take care while cleaning the lower body, and make sure the Switch is not damaged or disengaged.

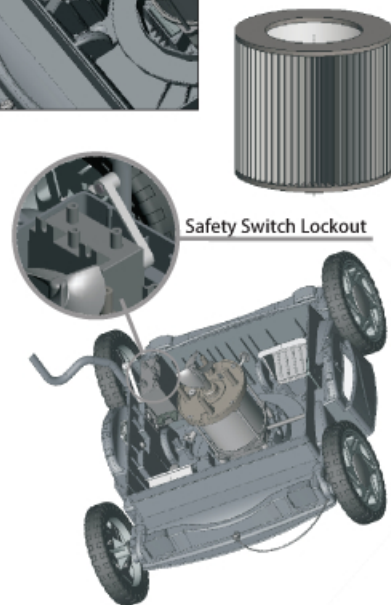

The Cleaner must be OFF while removing the Filter Cartridge to prevent accidental injury.

TROUBLE SHOOTING:

A. Does not reverse directions:

1. Take a garden hose and spray water into the valve housing at each opening. The high water pressure should free the jet valve system of any debris. Remove one of the jet-outlets, taking out the two lateral screws (FIG. 19).
2. Bend a common "giant" paper clip into a hook as shown in (FIG. 20) Push the center Flap to open it and look into the Impeller. Typically, you may find debris like hair, string, or a small twig caught in the impeller. Use your paper clip to hook or free the debris and remove it (FIG. 21).

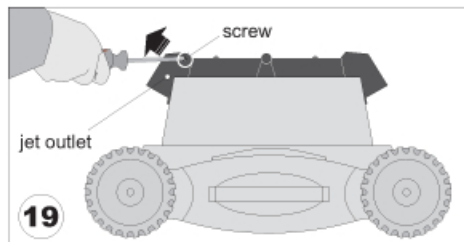

20



B. Does not pump water:

1. Check to see if the electric outlet has power.
2. Check to see if the cable is plugged into the power supply.
3. Check the fuse in the Power Supply - if necessary replace it.
4. Check the cable for possible cuts or damage.

C. Does Not Vacuum well or at all:

1. Check to see if the filter cartridge is not clogged.
2. Check to see if the intake valve flaps on the bottom of the cleaner are free to allow entry of water and debris
3. Lower Suction Outlets (see page 7).

D. Does not cover the entire pool:

1. Check to see if the wheel movement is free of obstructions like hair or accumulated debris.
2. Check to see if the filter cartridge is not clogged.
3. Adjust timing cycle so that the cleaner reaches the other side of the pool.

E. Floating cable and twisting cable care

1. Your new cleaner was designed to clean most above-ground pools. Some pool shapes may cause the cable to coil or tangle because the cleaner operates in a systematic circular pattern.

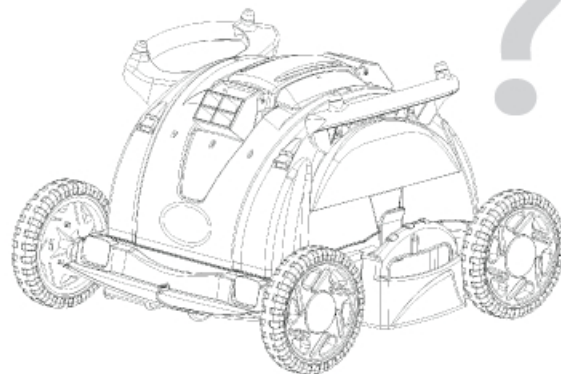
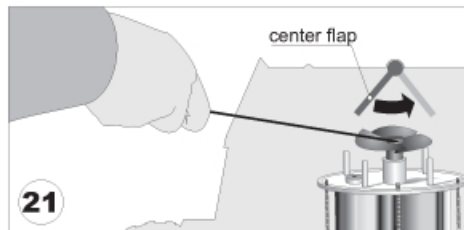

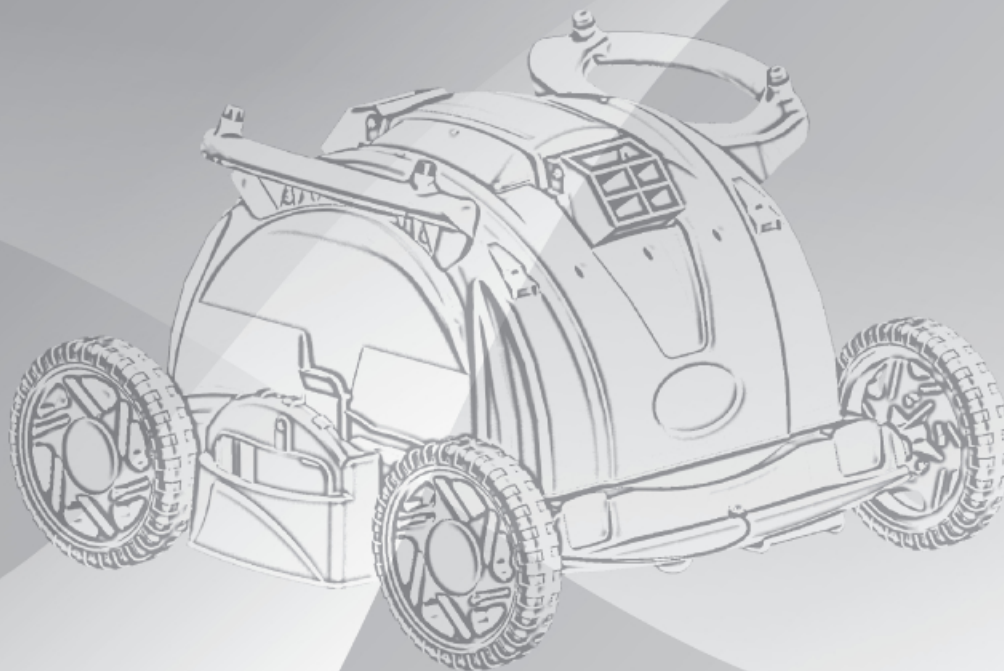

Aqua Products, Inc.
25 Rutgers Avenue
Cedar Grove, New Jersey 07009
1-800-221-1750
www.AquaProducts.com

