

Swimming Pool Technology

Svembadtechnologie

BADU[®] Clean *Supreme*
AUTOMATIC POOL CLEANER

Installation and Operation Manual



**Fast Start-up,
Safely Operate and
Efficiently Clean.**

speck
pumps 
SOUTH AFRICA (PTY) LTD

WARNING



SAFETY INSTRUCTIONS: Read prior to use.

SUCTION HAZARD

When using the pool cleaner, keep it away from the body parts when the cleaner is in operation.

CHILD DROWNING RISK

Adult use only. Never allow children to use the pool cleaner. Do not allow swimmers in the pool when the cleaner is in operation. Store out of reach of children.

PREPARING YOUR POOL

Before you assemble and install the **BADU®Clean Supreme**, we strongly recommend that you carry out the following steps to ensure your pool is ready for the **BADU®Clean Supreme** to operate.

1. Make sure the chemical balance of your pool water is correct.
2. Brush your pool and let any debris settle.
3. Vacuum your pool, using a manual vacuum cleaner.
4. Clean your pool filter, skimmer basket and pump strainer basket.
5. Close the pool main drain. (If your pool has one.)
6. Adjust your pool return lines so that the water flow is directed downwards to ensure complete cleaning of your pool. The flow of water from the return line(s) can affect the performance of your new **BADU®Clean Supreme**, as it can push it away from certain areas, or cause it to stay in one section of the pool. To turn the flow downward simply:
 - Loosen the lock ring
 - Turn the eyeball, so that the flow is directed downward.
 - Retighten the lock ring.
7. If necessary, replace the eyeball fitting with the Eyeball Diverter supplied with your **BADU®Clean Supreme**. To do so, simply:
 - Make sure the pool pump is switched off.
 - Unscrew the lock ring.
 - Replace the original eyeball with the Eyeball Diverter.
 - Make sure the Eyeball Diverter is positioned so as to direct the flow downwards.

Note: The Eyeball Diverter does not fit all pool return line fittings!

Installation and Operation Manual

BADU®Clean Supreme Automatic Pool Cleaner

Assembling & Installing your Pool Cleaner

STEP 1: Check Contents of the Box

Remove the **BADU®Clean Supreme** body and all parts from the box and check that the following components are included. Refer to figure 1.

Components Check List:

NO	DESCRIPTION	QUANTITY OF COMPONENTS
1	Cleaner complete with Footpad	1
2	Skirt	1
3	Hose Lengths*	10
4	Deflector Wheel	1
5	Hose Weights	3
6	Automatic Regulator Valve	1
7	Regulator Valve 2" Hose Cone	1
8	Eyeball Diverter and Outer Ring	1
9	Agile Adaptor	1
10	Installation and Operation Manual	1

Figure 1

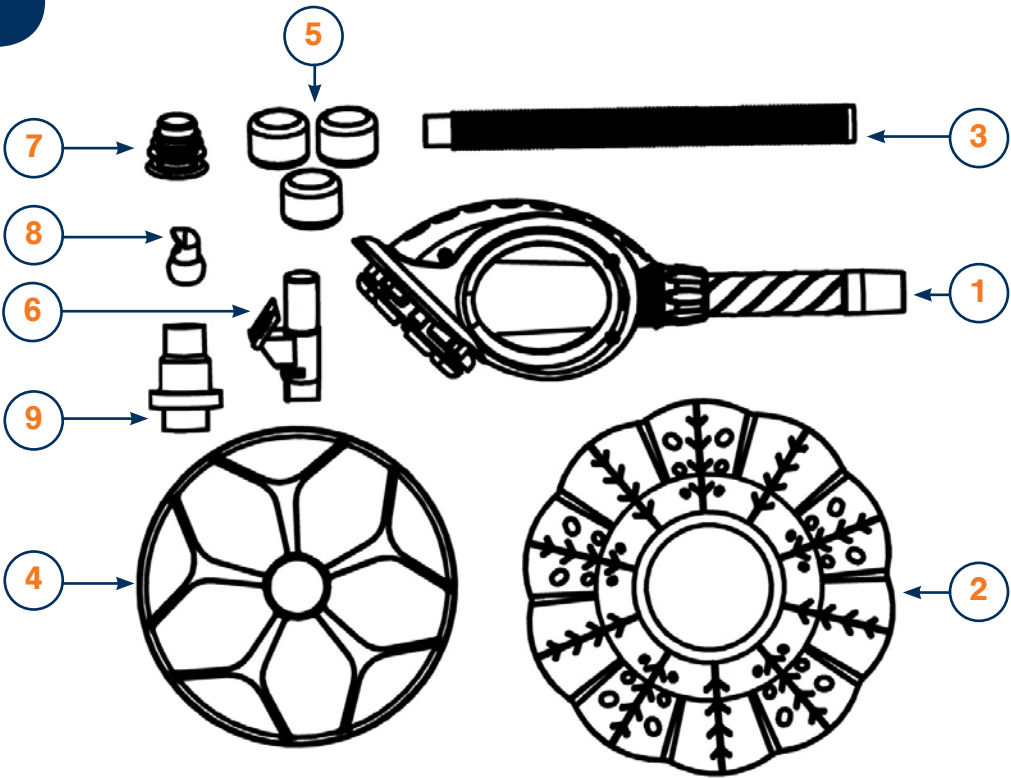

STEP 2: *Assemble the Pool Cleaner*

To assemble, simply fit your pool cleaner skirt to the body.

Simply stretch the skirt (with the fins pointing up, towards the cleaner) over the Footpad, as shown in Fig. 2.

Make sure the inside rim of the Skirt is located in the track that runs around the Footpad. When the Skirt is correctly positioned, it should easily rotate around the Footpad.

Figure 2

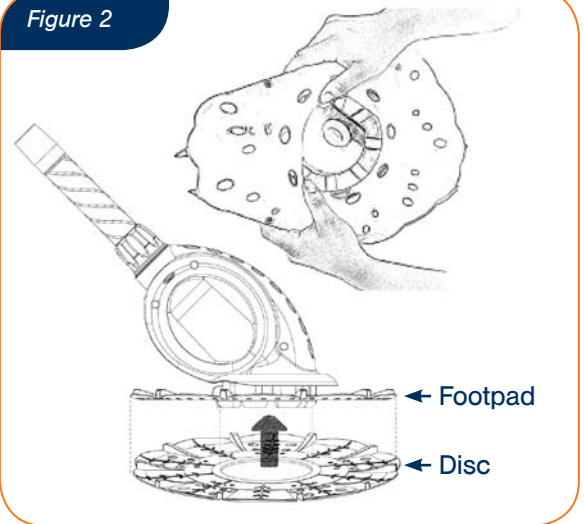

STEP 3. *Use of the Deflector Wheel*

Use the Deflector Wheel if your pool has tight corners and/or a ladder. The Deflector Wheel helps guide the **BADU®Clean Supreme** around these obstacles.

To fit the Deflector Wheel, simply push it over the Locking Nut, until it has engaged correctly and rotates freely. See Fig. 3.

Figure 3

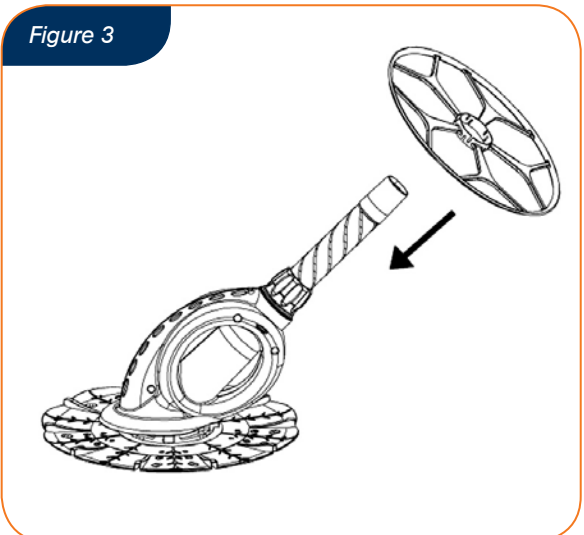

STEP 4. **Connect Hoses & Position the Hose Weight(s).**

Connect sufficient lengths of hoses to cover the distance from the pool skimmer or vacuum point, to the furthest point of your pool, plus one length. See Fig. 4.

Figure 4

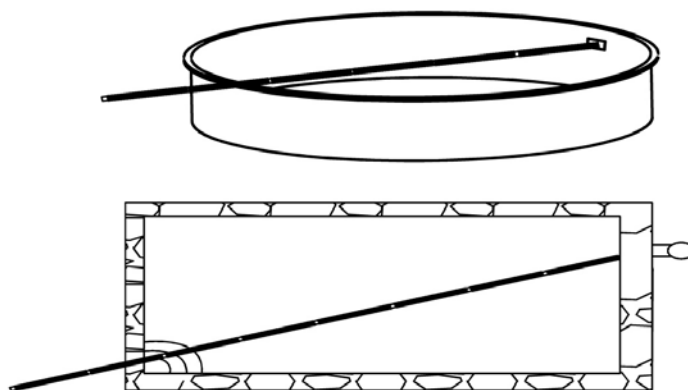

The Female (large) hose cuff is fitted to the **BADU®Clean Supreme**. Use the optional extra Agile Adaptor here. The male (small) hose cuff connects to the next hose. See Fig. 5.

Figure 5

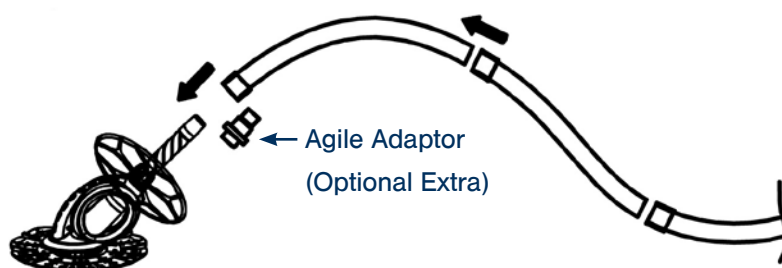

If you have a deep pool, you may need to fit the hose weights. This is to counteract excessive buoyancy created by the hose. The hose weights simply slides over the Male hose cuff and can then be positioned wherever required on the hose. Adjusting the position of the weights could provide better performance. See Fig. 6.

Figure 6

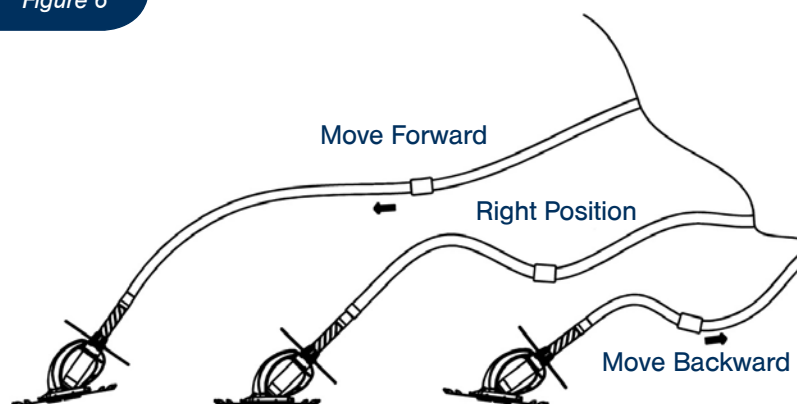

STEP 5. *Connect Hoses & Position the Automatic Regulator Valve.*

The Automatic Regulator valve ensures the **BADU®Clean Supreme** receives the flow required to ensure optimum performance.

- Make sure the pool pump is turned OFF.
- Expel all the air from the hose.
- Insert the Automatic Regulator Valve into the WEIR/Skimmer. If necessary, use the Regulator Valve 2" Hose Cone to ensure a good connection. See Fig. 7 & 8.
- Turn the pool pump ON.
- Your **BADU®Clean Supreme** will now begin automatically vacuuming your pool.

Figure 7

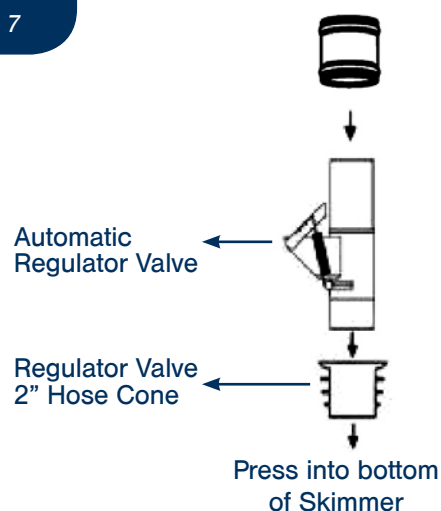

Figure 8

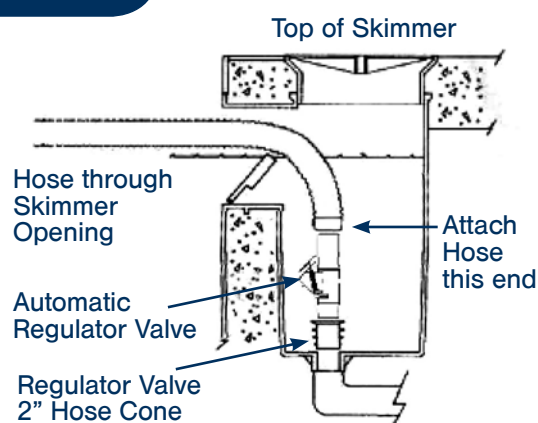
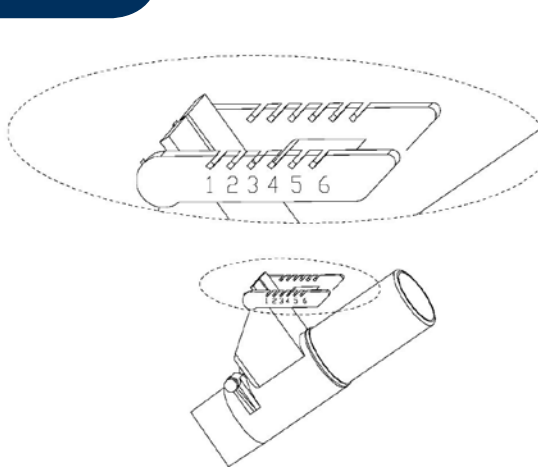

Figure 9



The Automatic Regulator Valve is preset between Positions 3-4. This provides the ideal operating flow in most pools. But if necessary, the flow can be adjusted by using any setting from Position 1 through 6 (1=minimum flow, to slow the cleaner down, 6 = maximum flow, your cleaner will run faster). See Fig. 9.

Troubleshooting

Due to the individual characteristics of your pool, some adjustments may be required to get the best possible performance from your new **BADU® Clean Supreme**.

The following tips will help you to optimize the performance of your new cleaner.

CHECKS	SOLUTIONS
1. If the pool cleaner is working slowly, runs then stops or not moving or pulsating at all.	<ul style="list-style-type: none">• Check to ensure that the main drain and all suction lines are closed, except for the suction line to which the cleaner is attached.• Check for debris in the weir/skimmer or pump baskets and check that all the baskets are in a good condition and are not broken.• Check for debris in the cleaner's diaphragm or for wear or damage.• Check that the filter has been backwashed and rinsed thoroughly.
2. If the cleaner stays at the shallow end steps.	<ul style="list-style-type: none">• Check and fit the Deflector Wheel.• Check that the hoses are long enough to reach the furthest point of the pool, including the pool steps.• Check the return line water flow and redirect as necessary with an eyeball diverter.
3. When the cleaner tracks in a repetitive pattern.	<ul style="list-style-type: none">• Check the return line water flow and redirect as necessary with an eyeball diverter.• Check that the hose weight positions are correct.• Check that the hoses are long enough to reach the furthest point of the pool, including the pool steps.

CHECKS	SOLUTIONS
<p>4. If the cleaner stays in one end of the pool.</p>	<ul style="list-style-type: none"> • Check the return line water flow and redirect as necessary with an eyeball diverter. • Check that the hoses are long enough to reach the furthest point of the pool, including the pool steps. • Check that the hose weight positions are correct.
<p>5. If the cleaner slows or stops and air bubbles enter the pool at the return line.</p>	<ul style="list-style-type: none"> • Check the hoses to ensure that there are no leaks. • Check the vacuum lid at the Automatic Regulator Valve connection. It should be submerged in the water so no air enters the system. Top up the water level if it is necessary. • Check the pump lid for looseness, cracks and worn or missing O-rings. If you need assistance contact your pool professionals.
<p>6. The pool cleaner falls on its side.</p>	<ul style="list-style-type: none"> • Make sure the outer extension pipe swivels freely.
<p>7. The Hose connection does not fit the Automatic Regulator Valve.</p>	<ul style="list-style-type: none"> • Fit the Regulator Valve 2" Hose Cone.

Routine Maintenance

To maintain the performance of your BADU® Clean Supreme:

- When removed from the pool, make sure the hose is stowed straight. Never coil the hose as this may cause distortion which may adversely affect the pool cleaner.
- Remove the pool cleaner (including hose) before chemical treatment. Wait a minimum of 4 hours after super chlorination (shock treatment) of your pool before re-installing the pool cleaner.
- Clean the filter, skimmer basket and pump basket regularly.
- When not in use, keep the cleaner Skirt flat, to avoid risk of warping.
- Periodically inspect your pool cleaner for signs of wear. If necessary, replace any worn parts.
- **NOTE:** Due to the harsh conditions in which your cleaner operates, its colour may fade and discolour over time.

Replacing the Diaphragm

The diaphragm of your pool cleaner operates at the rate of approximately 360 beats per minute. If your pool cleaner operates daily for 8 hours, the diaphragm will open and close over 60 000 0000 times in a year! The design has been perfected over many years and, properly cared for, the diaphragm will last for several seasons. In the event that it does become worn or damaged and needs to be replaced, simply follow these easy steps:

1. Unscrew the Lock Nut and remove it, together with the Outer Extension Pipe and the Thrust Washer. Place these items to one side.

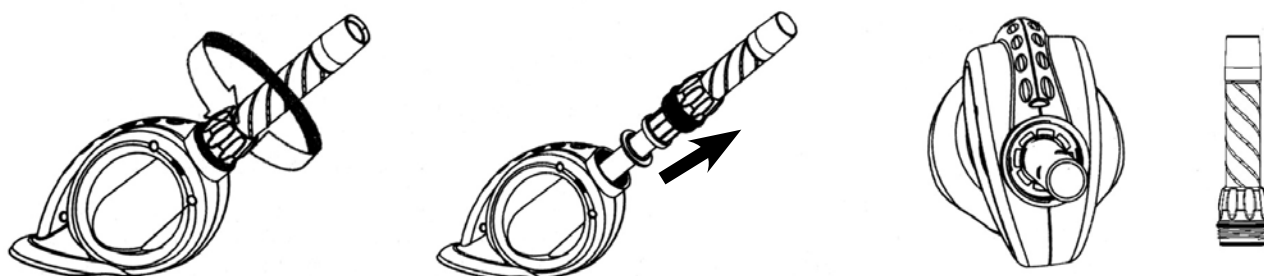

2. Hold the Inner Extension Pipe (IEP) and gently pull it towards you. This pulls the tabs out of their recess.

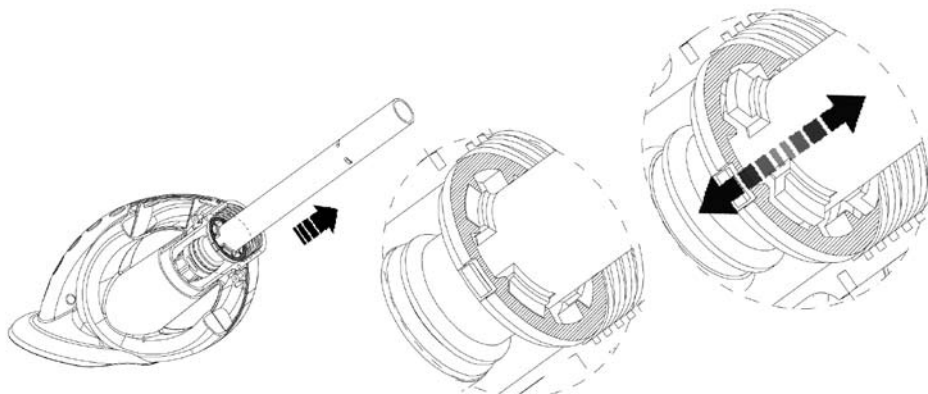

3. Turn the Inner Extension Pipe so the tabs line up with the holes in the IEP Locator. **Do not remove the Inner Extension Pipe from the body.**

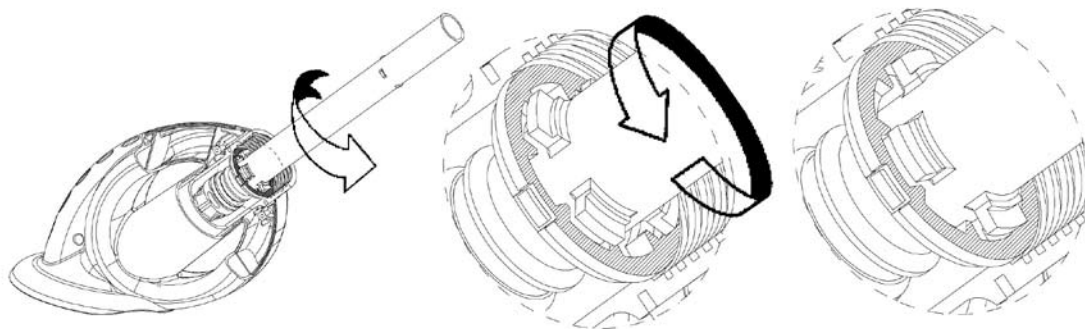

4. Push the Inner Extension Pipe away from you, so the tabs go through the holes in the IEP Locator.

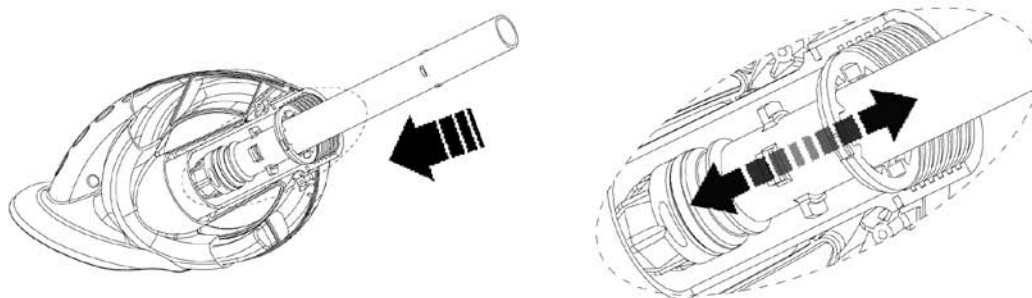

5. Grasp the other end of the Diaphragm (the end furthest away from the Inner Extension Pipe) and pull it away from the pool cleaner body. The Diaphragm will fall clear of the body.



6. Twist the Diaphragm, removing it from the Inner Extension Pipe.

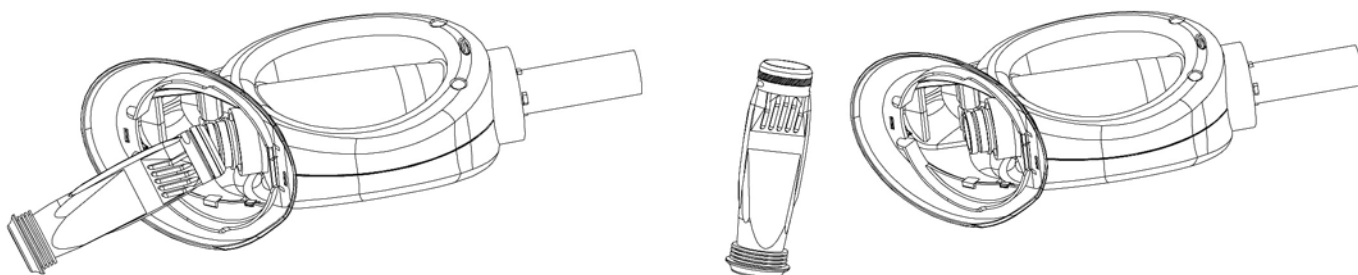

7. Remove the Retaining Ring from the Diaphragm. Discard the used Diaphragm.

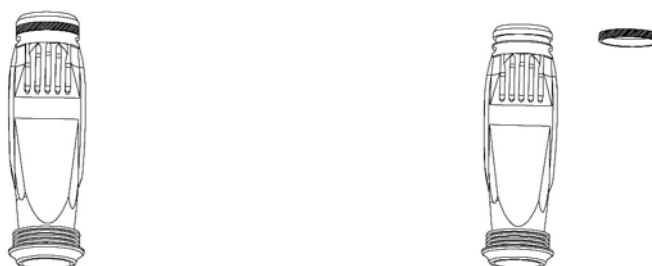

To install a new diaphragm, simply reverse the process:

- (a)** Fit the Retaining Ring onto the new Diaphragm.

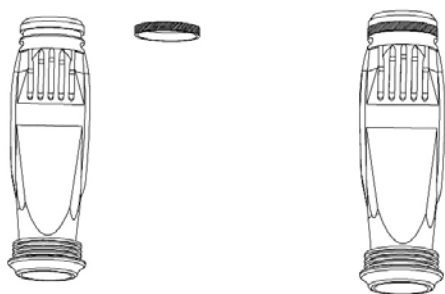

- (b)** Push the Diaphragm onto the Inner Extension Pipe.

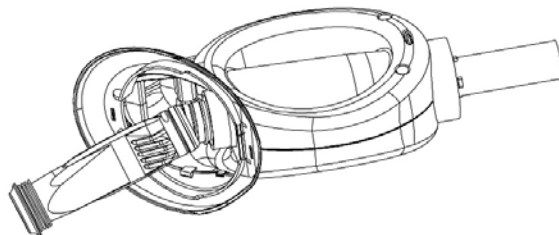

- (c)** Pull the Inner Extension Pipe up through the body, positioning the tabs so that they can be pulled through the holes in the IEP Locator.

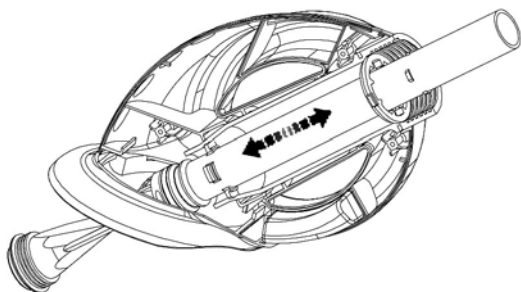

- (d)** Gently turn the Inner Extension Pipe so the tabs are aligned with the recesses in the IEP Locator. Release the Inner Extension Pipe.

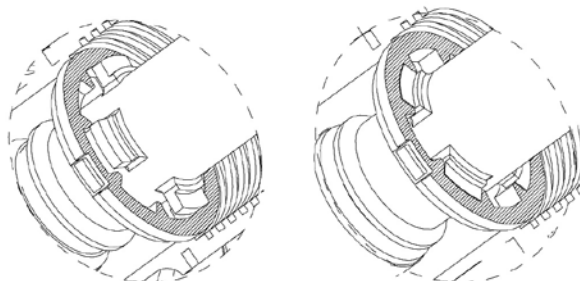

- (e)** Check that the Diaphragm is correctly located. If it has become twisted during the installation, simply untwist by slightly turning the open end of the Diaphragm.

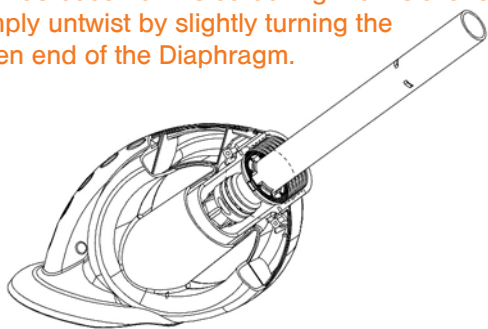

- (f)** Slide the Thrust Washer over the Inner Extension Pipe. The flat side (widest diameter) of the Thrust Washer should face down.

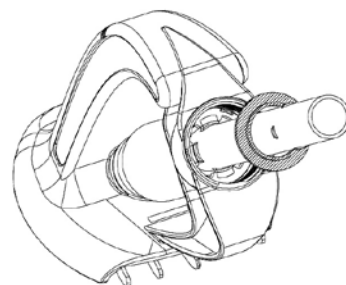

- (g)** Place the Outer Extension Pipe over the Inner Extension Pipe.

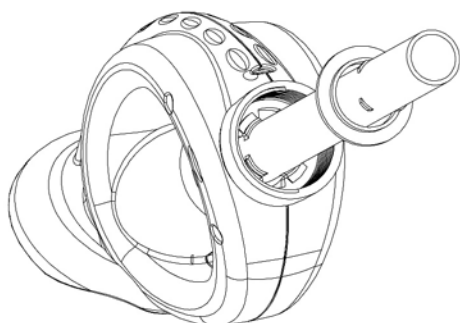

- (h)** Screw the Locking Nut into place to lock the assembly. Be careful not to over-tighten the Locking Nut.
(i) Check that the Outer Extension Pipe swivels freely.



Parts Diagram

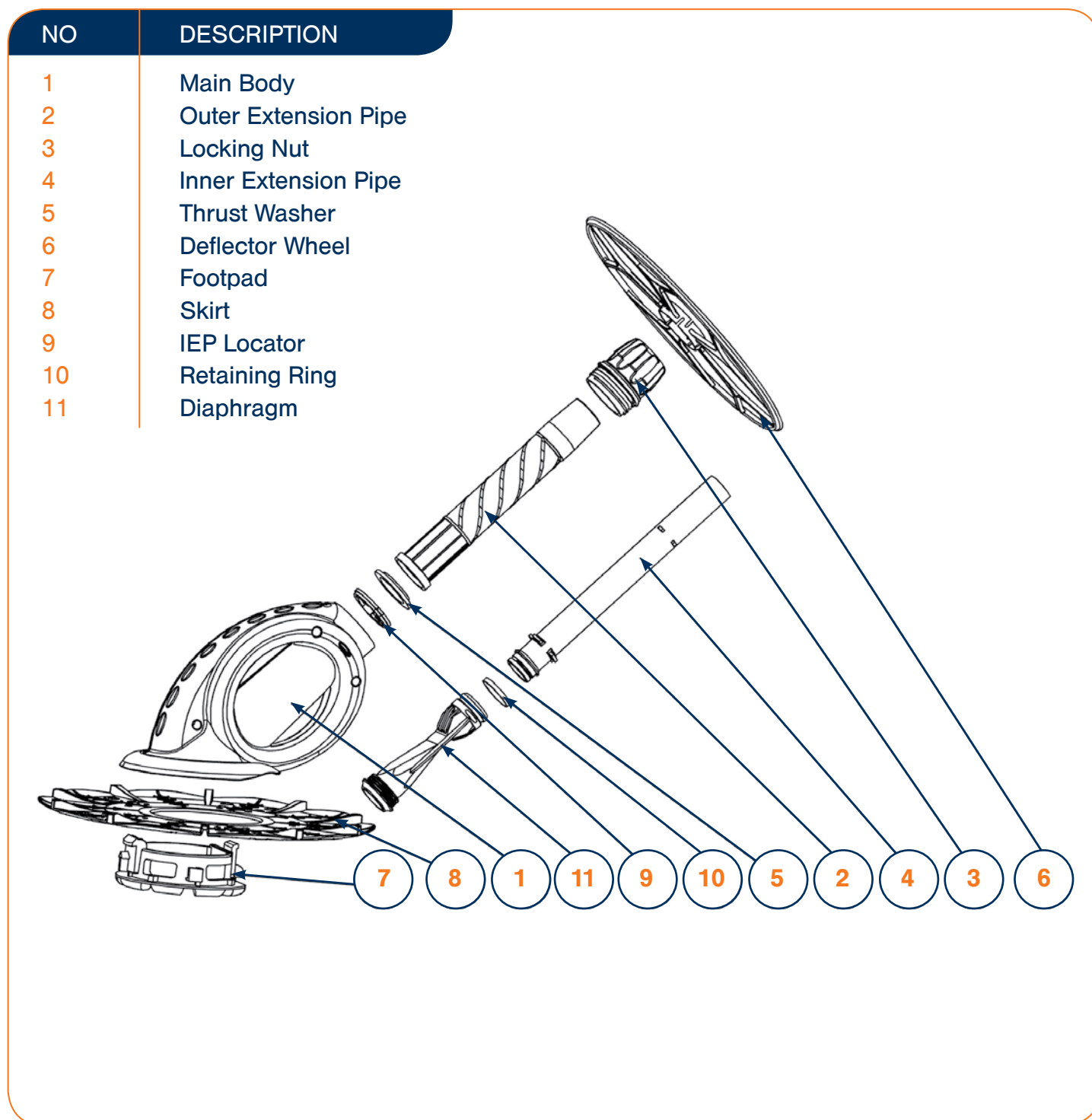

WARRANTY CARD

BADU®Clean Supreme

Your **BADU®Clean Supreme** Automatic Pool Cleaner is guaranteed to be free of defects in workmanship and materials for a period of 1 year from the date of purchase.

The warranty is limited to the replacement or repairs of defective parts only and excludes:

- All wearing parts which must be regularly checked and replaced when worn. These include the Footpad, Deflector Wheel, Skirt and Diaphragm.
- Any discoloration or fading of **BADU®Clean Supreme** parts.
- Any damage to the **BADU®Clean Supreme** resulting from improper or abnormal use or conditions, inadequate care and maintenance, and all such acts or omissions beyond our control.

The warranty is not transferable and replaces all other guarantees, representations, or warranties whether expressed or implied relating to the **BADU®Clean Supreme** including its merchantability and fitness for purpose.

This warranty is valid only within the border of the Republic of South Africa.

NAME:

ADDRESS:

..... CODE:

TEL. NO.: ()

NAME OF DEALER:

DATE OF PURCHASE:

SERIAL NUMBER:





EAST RAND BRANCH

P.O. Box 2425
Bedfordview, 2008
4 Bart Street
Wilbart
Germiston, 1609

Tel: +27 11 455-4300
Fax: +27 11 455-1949

CAPE TOWN BRANCH

P.O. Box 14703
Kenwyn, 7790
Cnr. Clifford Street &
Harris Drive, Sunset Park
Ottery, Cape Town, 7800

Tel: +27 21 704-1143
Fax: +27 21 703-4374

DURBAN BRANCH

P.O. Box 267
Pinetown, 3600
Unit 1 & 2, Goodwood Park
10 Goodwood Road
Westmead, Pinetown, 3610

Tel: +27 31 700-8005
Fax: +27 31 700-8006

PRETORIA BRANCH

P.O. Box 2425
Bedfordview, 2008
Unit 4, 123 Mosaic Street
Silvertondale, Pretoria
0184

Tel: +27 12 804-1294
Fax: +27 12 804-1295

WEST RAND BRANCH

P.O. Box 2425
Bedfordview, 2008
80 Schooner Street
Lazer Park, Honeydew
2040

Tel: +27 11 794-5212
Fax: +27 11 794-8142